



Unit 626 Kilshane Avenue, North West Business Park, Ballycoolin, Dublin 15, Ireland
Telephone: +353 1 8612 632, Fax: +353 1 8612 647, email: sales@driveriteltd.com

W21-760-3410 Iveco 35c – 50c (All Models 2007)

INSTALLATION INSTRUCTIONS

All work should be carried out in a properly equipped workshop with due regard to Health and Safety Regulations. No further reference to Health and Safety Regulations will be made, but they must be considered at all times.

The kit should be opened and the contents checked against the parts list provided.

Identify the various components and familiarise yourself with them using drawings and information provided.

WARNING

Do not inflate this assembly when it is unrestricted. When installed, a minimum of 10 psi should be maintained in the air bellows at all times to avoid damage. Do not inflate beyond 100 psi.

IMPORTANT

This kit is not designed to increase the GVW of your vehicle. For your safety and to prevent possible damage to your vehicle, do not exceed the maximum load recommended by the vehicle manufacturer.



Parts List

Description	QTY
Upper Bracket	2
Lower Bracket	2
Axle Strap	2
M10 Locknuts	8
M10X40 C/Sink Screw	4
3/8 UNF Flanged Nuts	4
3/8 Spring Washer	2
1/4" Tubing	18ft
Thermal Sleeves	2

Description	QTY
Air Springs	2
Cable Ties	10
M10X50 Bolts	4
M10 Washers	12
1/4" Elbow	2
3/8X3/4 UNC Bolt	2
Tee Piece	1
1/4" Inflation Valve	2



Special Instructions for Air Connections

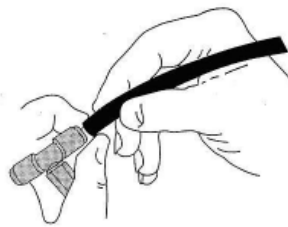

1. To cut the tubing correctly an appropriate cutter must be used (not a scissors)
2. When inserting the tubing into the connection it must be pushed in approximately 14mm until a click is heard.
3. To remove the tube, push the flange on the connection and at the same time pull the tube. (No tool is necessary.)
4. ATTENTION, when a tube is removed it is important to trim 14mm from the end before reconnection.
5. IT is advisable that LOCKTITE be used on the threaded fittings.

Important

- The Installation manual should be read entirely before beginning assembly.
- This kit does not increase the G.V.W. (gross vehicle weight) of your vehicle, for your safety and to avoid any damage to your vehicle do not exceed the maximum loading recommended by the manufacturer.
- Do not inflate air bags before assembly.
- Once the kit is installed, do not exceed the max and min pressure limits, incorrect use or over inflation can cause deterioration of your suspension.

PREPARATION:

In order for the kit to be installed on the vehicle, it is necessary firstly to provide free space within the range of the rear axle. Usually, there are no additional components which could interfere with installing the kits in this space. However, if components are interfering with mounting the kit, then it must be clarified whether it is still possible to mount this kit or whether these additional parts can be moved accordingly. You must always take care not to interfere with the vehicle parts, e.g. brake hoses, cables etc. These could be jammed or damaged while assembling the kit. In order to ensure this does not occur, they must be partially shifted.

INSTALLATION

Raise the chassis from the axle to create enough room to remove the bump stops. NOTE: Do not strain any brake lines or cables.

Remove the bump stops from the rear axle. The holes used to mount the bump stops will now be used to mount the upper bracket.



Assemble the bottom bracket to the air spring as shown, using 3/8" UNC nuts and spring washers.

Screw the elbow connection in into the top of the air spring. Use thread sealant for this procedure.



Install the upper bracket in place of the bump stop as in the photo. Fix in place using the M10X40 Countersunk bolts with the M10 washers and the M10 Locknuts. Make sure that the cut-out in the support of the upper bracket is pointing in board and towards the front of the vehicle.



Before mounting the air spring the bracket welded to the axle must be bent downwards.



Unscrew the "Bleed-off Tube" on the left hand side of the axle. This is an 8mm tube that is threaded into the top of the axle



Now mount the air spring and lower bracket between the upper bracket and the axle as in photo.



Make sure that the end of the lower bracket fits between the u-bolts on the leaf springs making it impossible to rotate the bracket.



Fasten the air spring to the upper bracket using the 3/8" hex head bolt. Finally examine the air spring and make sure that no parts of the vehicle will interfere with it during operating conditions.



Attach the lower bracket to the axle using the axle straps with the M10X50 bolts, M10 locknuts and M10 washers.

Insert the 1/4" tubing into the elbow connector in the base of the air spring. Root the 1/4" tubing along the framework to the inflation valves.



Cut a long length of tubing in order to connect the valve to the nearest air bag. Do the same for the opposite side. Choose whether you want separate inflation valves for each side or one valve common to both sides using the T shaped connector. Use the nylon ties provided to tie the tubing up into a safe position.

Drill an 8 mm (5/16") hole and mount the inflation valve as shown in the diagram, pushing the valve through the hole from behind and attaching with 2 washers and a nut.

Cut the air tube to length, making sure the end is cut squarely, and push the end as far as possible into the back of the inflation valve.

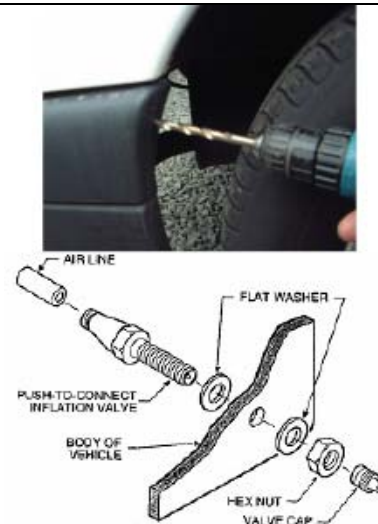

OPTION:

To mount a pressure gauge inside the rear of the vehicle. Cut the air tube squarely a short distance back from the inflation valve, and insert the ends of the tubes into a Tee fitting. Cut a length of tube long enough to reach from the T fitting to the gauge. Feed the air tube up from below and connect the tube into the gauge and the Tee fitting.

IMPORTANT:

Attach all tubing securely to the underneath of the vehicle using nylon ties.

Do not attach to break lines.

Protect the tube with the sleeves provided where there are any sharp edges or sources of heat.

If the vehicle is fitted with ABS and Load Sensing Valve (LSV), then adjust the LSV to give maximum braking (1:1).

If the vehicle is fitted with ABS and no LSV, then no brake adjustment is required.

For vehicles without ABS, please contact us on +353 1 8612 632

Examination:

After assembly, inflate air bellows and check all mounting bolts are tight. Screw all connections tight again. It must be ensured that the mounting brackets can not move. If the plates touch the brake hose at the air bellows, then these must be moved by suitable means.

After having carried out the assembly, having inflated the Air springs and having checked that all the bolts as well as the pneumatic connections are quite tight. You must make sure that the mounting plates cannot move. If brackets touch the brake cables towards the Airbags, then they must be moved with adapted means.

Precautions:

Never exceed the maximum and minimum recommended pressure limits.

Min pressure 1bar

Max pressure 7bar

Never drive with deflated air bags.