



Unit 626 Kilshane Avenue, North West Business Park, Ballycoolin, Dublin 15, Ireland  
 Telephone: +353 1 8612 632, Fax: +353 1 8612 647, email: sales@driveriteltd.com

## W21-760-2447

### INSTALLATION INSTRUCTIONS

All work should be carried out in a properly equipped workshop with due regard to Health and Safety Regulations. No further reference to Health and Safety Regulations will be made, but they must be considered at all times.

The kit should be opened and the contents checked against the parts list provided.

Identify the various components and familiarise yourself with them using drawings and information provided.

#### **WARNING**

*Do not inflate this assembly when it is unrestricted. When installed, a minimum of 10 psi should be maintained in the air bellows at all times to avoid damage. Do not inflate beyond 100 psi.*

#### **IMPORTANT**

*This kit is not designed to increase the GVW of your vehicle. For your safety and to prevent possible damage to your vehicle, do not exceed the maximum load recommended by the vehicle manufacturer.*

AIR SPRING	6397	2	3/8"-16 X 3/4" FLAT HEAD BOLT	4	
LEFT UPPER BRACKET	5548	1	3/8"-16 X 4" CARRIAGE BOLT	4	
RIGHT UPPER BRACKET	5549	1	3/8"-16 FLANGE LOCK NUT	8	
LOWER BRACKET	5552	2	5/8"-18 NYLON JAM NUT	2	
LOWER BRACE	5553	2	5/16" FLAT WASHER	4	
FRAME CLAMP	5550	2	INFLATION VALVE	3032	2
SPACER	5551	2	MALE CONNECTOR	3055	2
AXLE STRAP	0530	2	18 ft. TUBING	0938	1
HEAT SHIELD		1	THERMAL SLEEVE	0899	2
3/8"-16 X 3/4" HEX HEAD BOLT		4	NYLON TIE WRAP		6
3/8"-16 X 3/4" FLANGE BOLT		2	CAUTION TAG		2

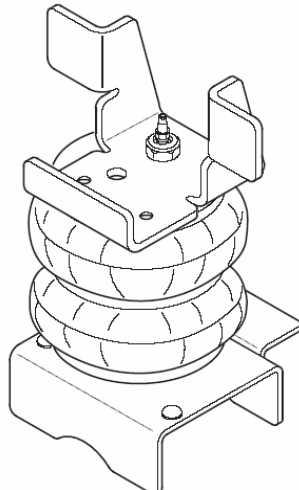
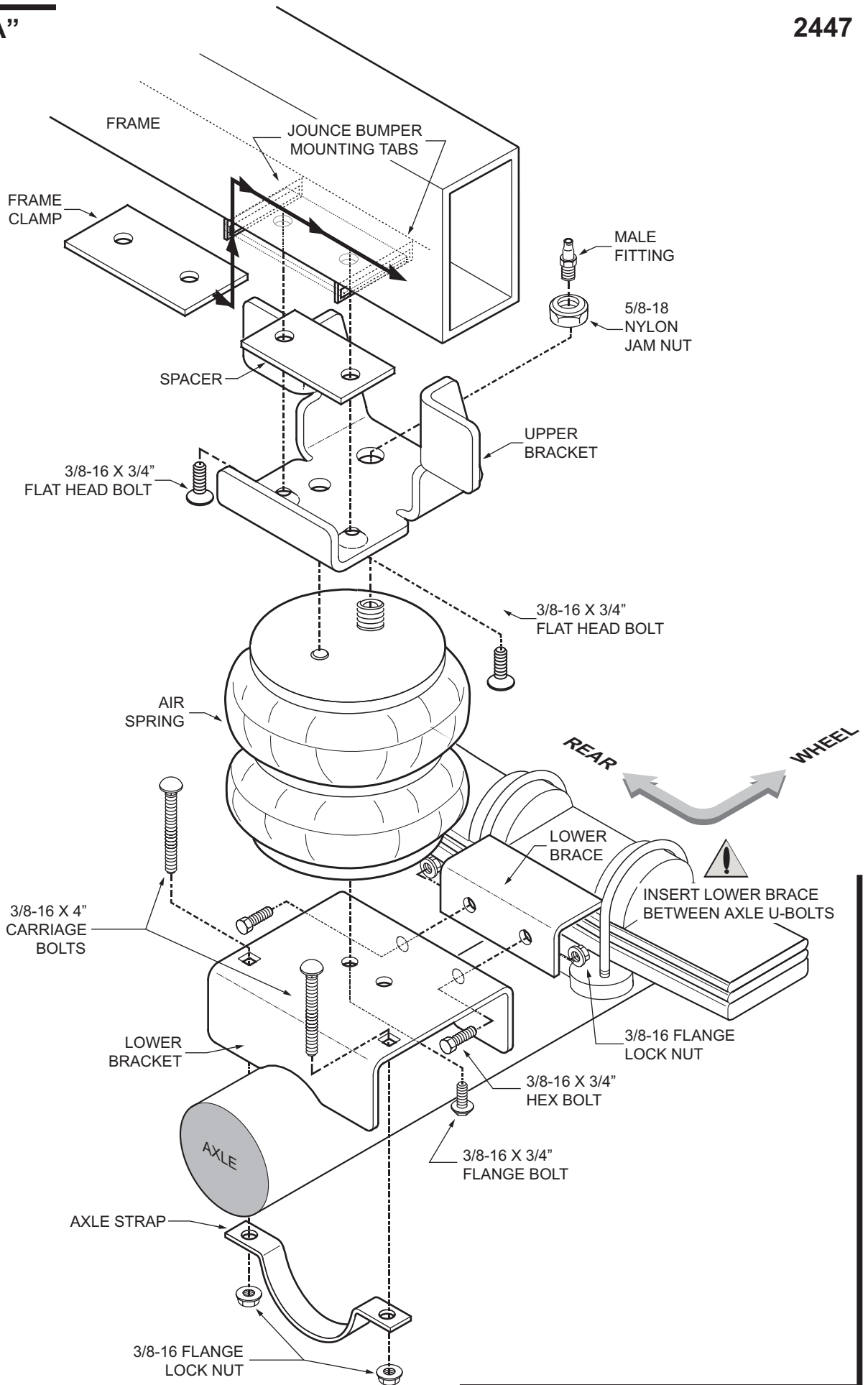
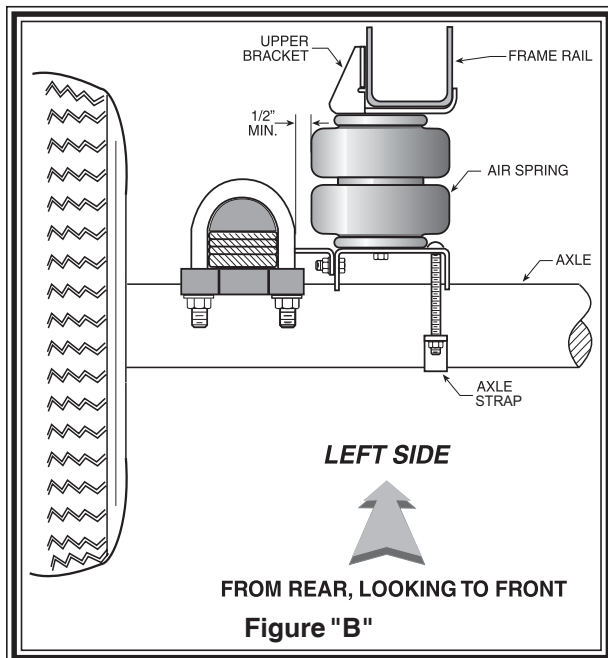

FIGURE "A"





LEFT SIDE  
FROM REAR, LOOKING TO FRONT  
Figure "B"

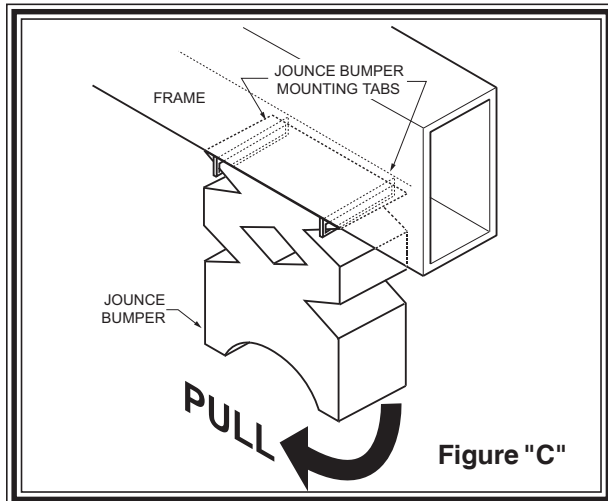

Figure "C"

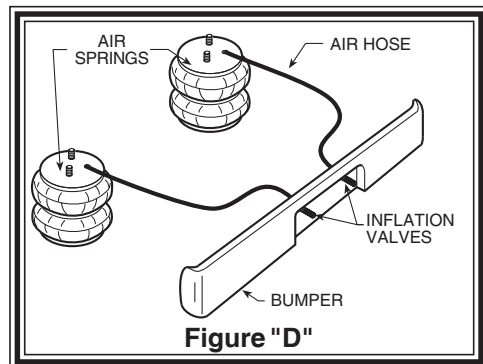

Figure "D"

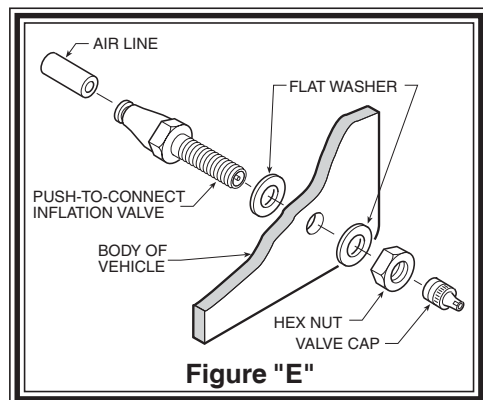

Figure "E"

**NOTE:** Please read through this manual completely before installing the air spring kit to your vehicle. All illustrations reference the left side of the vehicle. Reverse all orientations for the right side.

### STEP 1 - PREPARE THE VEHICLE

With the vehicle on a solid, level surface, chock the front wheels. Raise the vehicle by the axle, remove the rear wheels, and lower the vehicle on to jack stands rated to your vehicles weight. Remove the negative battery cable.

Remove the vehicle's existing rubber jounce bumpers as shown in *Figure "C"*. The jounce bumpers will not be reused.

### STEP 2 - UPPER BRACKET INSTALLATION

Slide the frame clamp into the jounce bumper mounting tabs on the bottom of the frame, from the rear of the vehicle, towards the front, *see Figure "A"*. Before the upper bracket is attached to the frame clamp, place the spacer on the upper bracket, then insert two 3/8"-16 X 3/4" flat head bolts through the upper bracket and the spacer. Next attach the upper bracket and spacer to the frame clamp. See *Figure "A"*.

### STEP 3 - KIT ASSEMBLY INSTALLATION

Select one lower bracket and one lower brace. Attach the brace to the lower bracket using two 3/8"-16 X 3/4" hex bolts and two 3/8"-16 flange lock nuts as shown in *Figure "A"*. Next, attach an air spring to the lower bracket using a 3/8"-16 X 3/4" flange bolt. *See Figure "A"*. Insert two of the 3/8"-16 X 4" carriage bolts into the square holes in the lower bracket. Place the air spring assembly on the axle, making sure that the brace is positioned between the axle u-bolts. *See Figure "A"*. Insert an axle clamp onto the carriage bolts and install two 3/8"-16 flange lock nuts. *See Figure "A"*.

Next, insert the combination stud on the air spring into the large hole in the upper bracket, and the small alignment pin into the small hole. *See Figure "A"*. Attach the air spring to the upper bracket using one of the 5/8"-18 nylon jam nuts. Install the male fitting into the combination stud on the air spring. Tighten the air fitting securely to engage the orange thread sealant. *See Figure "A"*.

### STEP 4 - INSTALLATION OF THE RIGHT SIDE

*Note: The use of a heat shield is required on the passenger's side of the vehicle, see Figure "F"*. The heat shield will mount between the upper bracket and the air helper spring. Bend the heat shield so it will fall halfway between the air helper spring and the closest point on the exhaust. Be sure that the heat shield will not contact any other component as the suspension compresses (*i.e.* brake lines, shock absorbers, lower bracket assembly). Follow steps 1-3 with reverse orientations for assembly and installation of the right side.

### STEP 5 - INSTALL THE AIR LINE AND INFLATION VALVE

Uncoil the airline tubing and cut it into two equal lengths. **DO NOT FOLD OR KINK THE AIRLINE TUBING.** Try to make the cut as square as possible. Insert one end of the airline tubing into the air fitting installed in the top of the air helper spring.

